

ROTARY TILTING TABLE with DD MOTOR NEW

NIKKEN

High-Acceleration / High-Speed / Compact Unit

- Indexing of 90° on Rotary Axis : Within 0.2sec. Tilting Axis : Within 0.3sec.
- Suitable for the machining of the impeller.



Suitable for the machining of the impeller.

5AX-DD200AF2



WITH
FACE
PLATE

★The tilting axis center is located in the same position as the center of the rotary axis body for 5AX-200A.

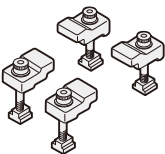
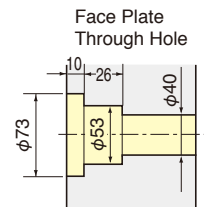
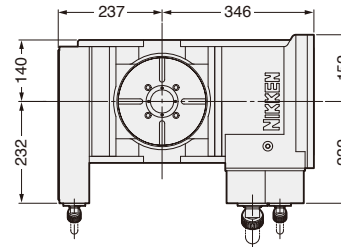
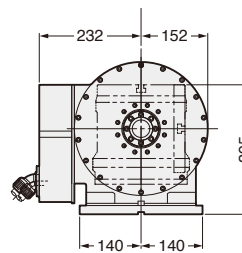

Clamp Device

5AX-DD200BF2

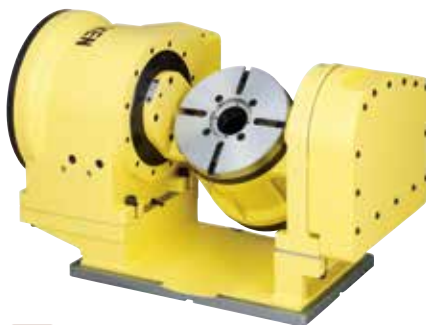

WITH
FACE
PLATE

★The tilting axis center is located in the same position as the center of the rotary axis body for 5AX-200B.

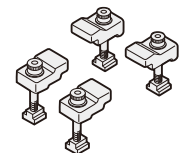
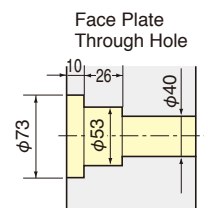
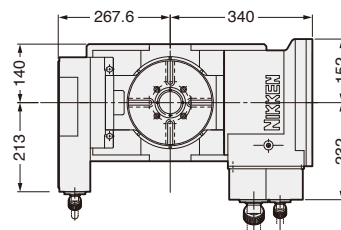
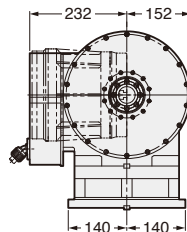

Clamp Device

Specifications The external dimension and the specification will be varied according to the DD motor. Please contact us.

Item / Code No.	5AX-DD200AF2		5AX-DD200BF2	
	Rotary	Tilting (±110°)	Rotary	Tilting (±110°)
Diameter of Spindle Hole	φmm	53H7	53H7	53H7
Center Height (90°)	mm	195	270	270
Table Height in Horizontal Position (0°)	mm	295	270	270
Width of T Slot	mm	12H7	12H7	12H7
Clamping System	Pneumatic*1 (0.5MPa)	Pneumatic*1 (0.5MPa)	Pneumatic*1 (0.5MPa)	Pneumatic*1 (0.5MPa)
Clamping Torque	Nm	150	150	500
Motor (FANUC)	DiS60/400	DiS150/300	DiS60/400	DiS150/300
Encoder	α iCz 512A		α iCz 512A	
Min. Incremental	deg.	0.001	0.001	0.001
Rotation Speed	min ⁻¹	200	200	150
indexing Accuracy	sec.	±10	±10	±15
MAX. Torque	Nm	130	130	380
Constant Torque	Nm	24	24	73/170*2
Net Weight	kg	190	185	185
MAX. Work Load	0~30deg. kg	30	30	30
	0~90deg. kg	15	30	30

*1 Air Intensifying Booster system is available if the supplied air pressure is under 0.5MPa or the brake torque is required to increase. **P.95**

*2 Shows the figure with cooling system.

CNC
NCT
NSV
NST
5AX
DD
BUILT-IN
MOTORS
M-SIGNAL
ACC
O/P
TEC
SERV

ROTARY TILTING TABLE with DD MOTOR



5AX-DD Table for FANUC ROBO DRILL 5AX-DD200AF2



WITH
FACE
PLATE

Layout for the ROBO DRILL
with 200mm high column

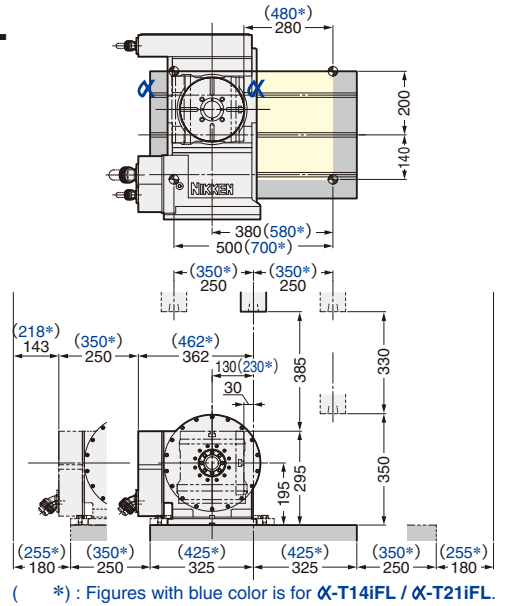
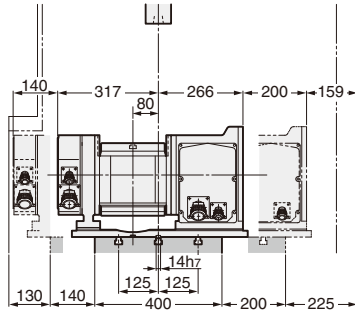

5AX-DD200BF2



WITH
FACE
PLATE

Layout for the ROBO DRILL
with 200mm high column

*1 The stroke restriction of 50mm
for the standard cover.
The stroke restriction of
110mm for the metal cover.

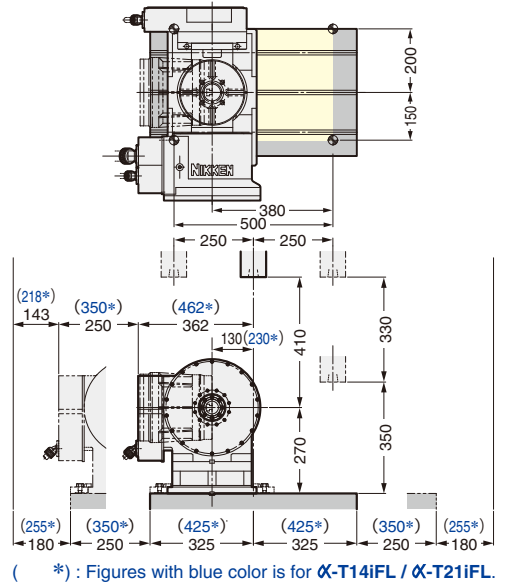
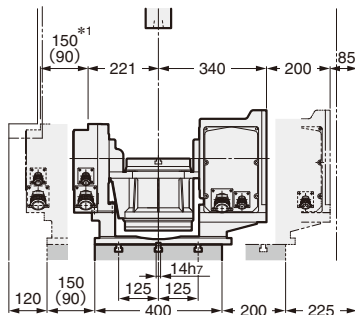

The Area of Noninterference in Tilting Position.



5AX-DD200AF2

Angle	5AX-DD200AF2	5AX-DD200BF2
-45° ∩ 45°		
-90° ∩ 90°		
-110° ∩ 110°		