

5AX

TILTING ROTARY TABLE

New

THE SMALLEST TILTING CNC ROTARY TABLE FOR COMPACT MACHINES

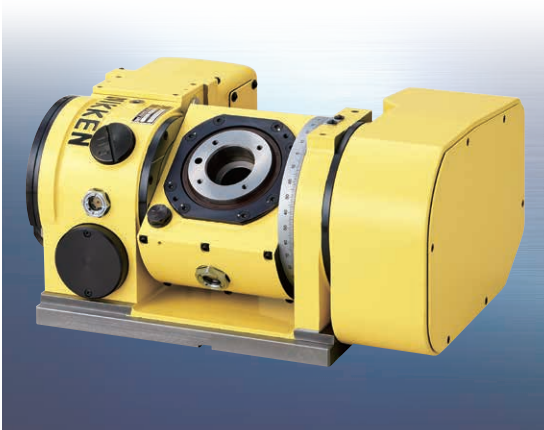

Ultra Compact Tilting Rotary Table

5AX-100 PAT.

Option

ADD. AXIS
P.57

ACCURACY SPEC.
P.99

ROTARY JOINT
P.89

ULTRA PRECISIO
P.87

TAIL STOCK
P.81

POWER CHUCK
P.84

CLAMP DEVICE
P.85

T-NUT
P.86

Accessories

Minimum & Lightest Weight

The Smallest and Lightest 5AX

Demonstrates the true worth of a compact machining center with limited machining space.

With a body width of 466mm and product weight of 84 kg, the 5AX series is the smallest and lightest tilting rotary table in NIKKEN's history. It is an ideal counterpart to products such as the BT30 compact machining center. It allows you to secure more machining space than was possible with earlier models.

Tilting Axis 600Nm

Powerful braking system with double clamping sleeve type PAT. Tilt-axis with Air-hydraulic unit as Standard Equipment.

Astoundingly powerful clamping capability in spite of compact body.

For machines with no hydraulic power source, the tilt-axis is equipped with an air-hydro unit that provides powerful hydraulic clamping using only an air supply. In spite of its compact body, it delivers an astounding 600 Nm of clamping power, enabling high positioning accuracy for highly precise machining.

Extensive Lineup of Attachments

This extensive attachment lineup from NIKKEN allows machining of a wide variety of work pieces.



Jig Plate



Scroll Chuck



Center Socket

High-precision 5-axis machining of precision electronic devices such as smartphones, automobile parts, etc. can be accomplished using a compact machining center.



Impeller

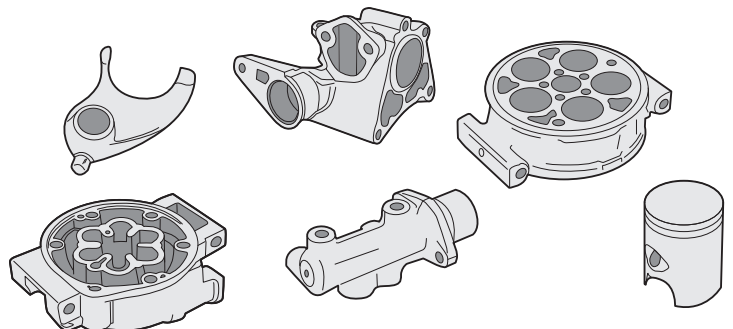

Components of Automotive Parts