

# CNC321T, 401T, 501T, 601T

**NIKKEN**

CNC

External dimensions depend on the type of the servo motor. Indicated dimensions are in case of FANUC. Please contact us for CAD files (2D:DXF, 3D:PARASOLID).

## CNC321T

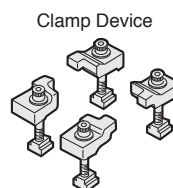
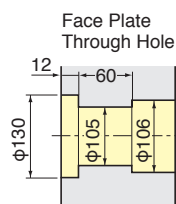
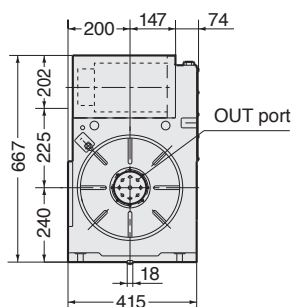
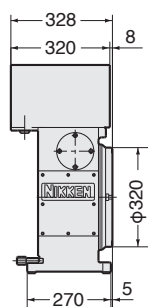

Rotary joint shown in layout is optional. In ports are located in back side.

## CNC401T

★ Built-in type rotary joint can be mounted on CNC401 refer [P.89](#)

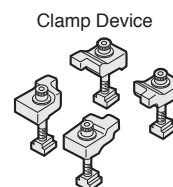
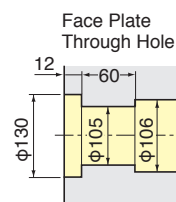
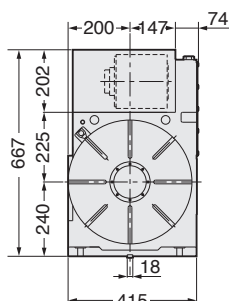
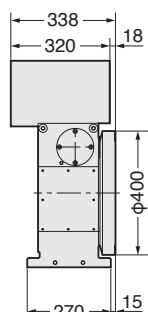

Center socket shown in photo is optional. In ports are located in back side.

## CNC501T

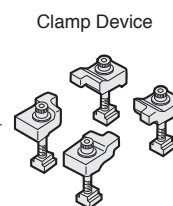
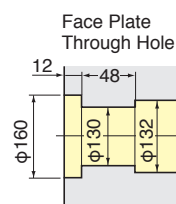
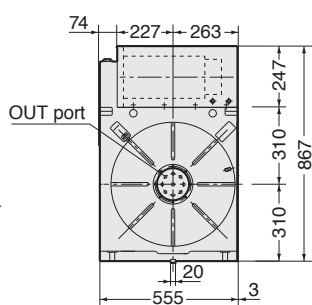
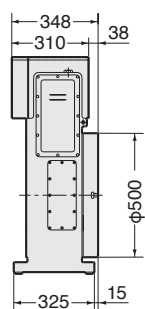

Rotary joint shown in layout is optional. In ports are located in back side.

## CNC601T

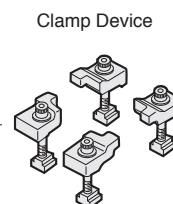
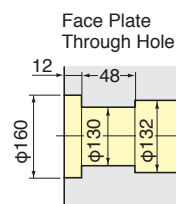
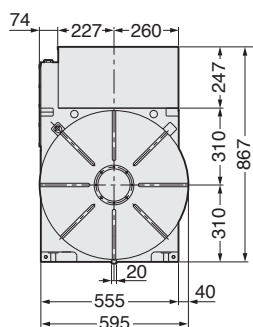
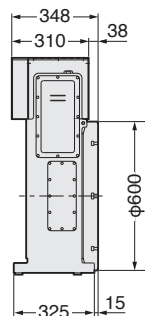

In ports are located in back side.