

# ADAPTER FOR QUICK TYPE ANGULAR HEAD

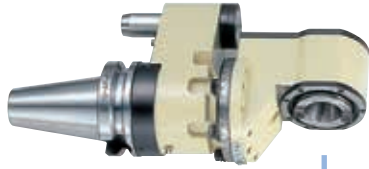

Quick type Angular Head  
☞ P.145

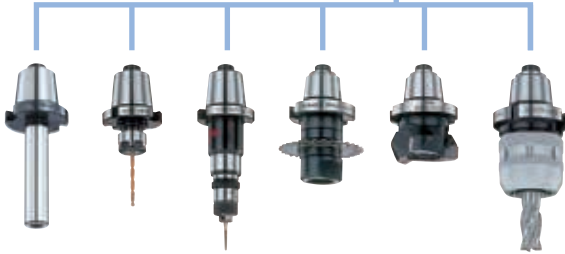

Quick type Milling Chuck (Double Face Contact)

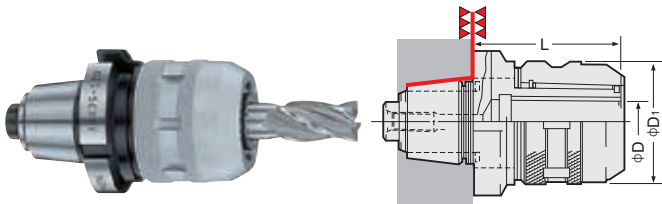

Code No.	D	L	D <sub>1</sub>	Weight(kg)	KM Collet
AHK30-C16		60	44	1.0	<b>KM16</b>
AHK35-C16,C20		60, 65	44, 52	1.1, 1.2	<b>KM16</b> <b>KM20</b>

★For KM COLLET, please refer ☞ P.35.

Quick type NIKKEN PRO-CUT (Double Face Contact)

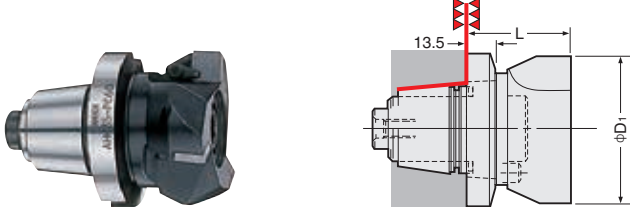

Code No.	PC.No.	L	D <sub>1</sub>	Weight(kg)
AHK30-PC50		45	50	0.7
AHK35-PC60,PC80		45, 57	60, 80	0.9, 1.3

★Inserts are standard accessory.

Quick type Side Cutter Arbor (Double Face Contact)

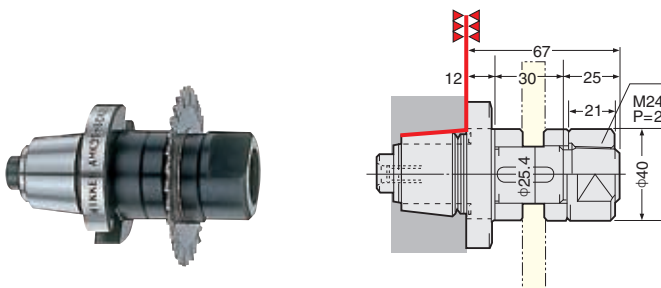

Code No.	L	D	D <sub>1</sub>	Weight(kg)
AHK35-SCA25.4	12	25.4	40	1.1

★The key and set of distance collars are standard accessory.

Quick type Slim Chuck



Code No.	SK.No.	D	L	D <sub>1</sub>	Weight(kg)	SK Collet
AHK30-SK10		1.75~10	35	27.5	0.4	<b>SK10</b>
-SK16		2.75~16	50	40	0.6	<b>SK16</b>
AHK35-SK10		1.75~10	35	27.5	0.5	<b>SK10</b>
-SK16		2.75~16	50	40	0.7	<b>SK16</b>

★SK Collet is not included, please refer ☞ P.47.

Quick type Tapper Chuck



Code No.	Z.No.	L	Weight(kg)	Tap Collet
AHK30-Z8, Z12		85, 100	0.6, 0.9	<b>ZKN 8</b> <b>ZKG12</b>
AHK35-Z8, Z12, Z16		75, 85, 100	0.7, 1.0, 1.5	<b>ZKN 8</b> <b>ZKG12</b> <b>ZKG16</b>

★Tapping Capability Z8 : M2~8 Z12 : M2~12 Z16 : M3~20

★Tap Collet is not included, please refer ☞ P.67.

Quick type Face Mill Arbor (Double Face Contact)

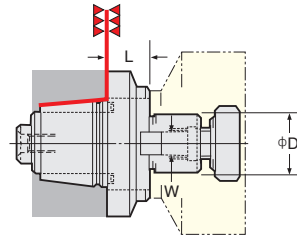

Code No.	L	D <sub>1</sub>	W	Weight(kg)
AHK35-FMA25.4	18.5	25.4	9.5	0.7
-FMA31.75		31.75	12.7	0.8

★The Keys and a Bolt are standard accessory.

Quick type Morse Taper Sleeve

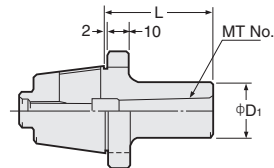

Code No.	MT.No.	L	D <sub>1</sub>	Weight(kg)
AHK30-MT1, MT2		50, 65	25, 32	0.4, 0.5
AHK35-MT1, MT2, MT3		50, 60, 85	25, 32, 40	0.5, 0.6, 0.9

Quick type Drill Chuck Adapter

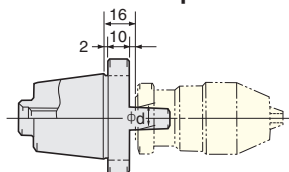

Code No.	J.No.	L	J.No.	Weight(kg)
AHK30-J6	J6	16		0.4
AHK35-J6				0.5

★This adapter is supplied without drill chuck.