

MINI-MINI MASTER CHUCK

High Rigidity, Heavy Duty Mini-mini Chuck

NEW



- Dual purpose tool holder for roughing & finishing
- Effective for processing difficult-to-cut materials
- High torque VMK-H collet is also available

Increased gripping force with TiN bearing

Run-out accuracy : 0.003mm at 4D

High speed milling : MAX 20,000min⁻¹ & G2.5

NIKKEN

NIKKEN KOSAKUSHO WORKS, LTD.
5-1, 1-chome, Minamishinden, Daito-shi, Osaka-fu, Japan

Web: www.nikken-kosakusho.co.jp/en
Tel: +81-(0)72-869-5820 Fax: +81-(0)72-869-6220
e-mail: export@nikken-kosakusho.co.jp

MINI MINI MASTER CHUCK

NIKKEN



MMC-ATB

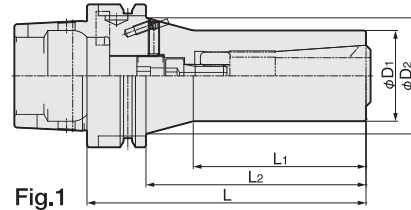

Fig.1

HSK

Taper	Code No.	φD	L	φD1	φD2	L1	L2	Collet	Fig	Weight (Kg)
HSK63A	HSK 63A-MMC16C-125-ATB	10~16	125	40	52.7	76	97	VMK16	1	1.4
	-MMC20C-125-ATB	12~20		47	52.9	89		VMK20	1	1.6
HSK100A	HSK100A-MMC16C-132-ATB	10~16	132	40	70.8	73.5	101	VMK16	1	2.8
	-MMC20C-132-ATB	12~20		47		85.3		VMK20	1	3.0



MMC-ATB

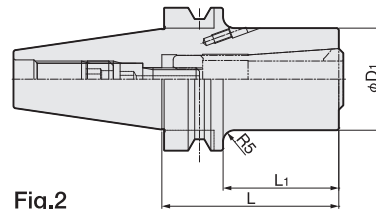

Fig.2

NBT

Taper	Code No.	φD	L	φD1	φD2	L1	L2	Collet	Fig	Weight (Kg)
NBT40	NBT40-MMC16C-80-ATB	10~16	80	45	-	51	-	VMK16	2	1.4
	-MMC20C-85-ATB	12~20	85	50		56		VMK20	2	1.5
NBT50	NBT50-MMC16C-80-ATB	10~16	80	45	-	40	-	VMK16	2	3.9
	-MMC20C-85-ATB	12~20	85	50		45		VMK20	2	4.0

- ★ Nikken recommend using Mini-mini Master Chuck with VMK-H collets.
- ★ Wrench is attached as standard.
- ★ Balance adjustment screw is available as an option. The Code No. of the screw is 9SFB-ASC-M4-3, 4, 6
- ★ Mounting handle is available as an option. The Code No. of the handle is 9SFB-AL-M2
- ★ Set Code for handle and all screws are S.9SFB-ASC-M4

HIGH TORQUE VMK-H COLLET

NIKKEN



VMK-H

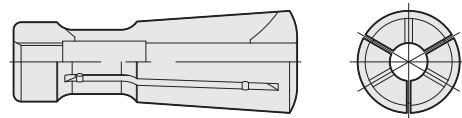

Explanation of the Code No.

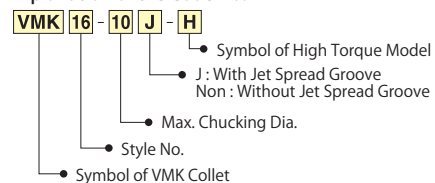

VMK-Hコレット Code No.	Chucking Minimum Capacity
VMK16-10, 12, 16-H	40, 42, 42
VMK20-12, 16, 20-H	47, 47, 47

VMK-Hコレット Code No.	Chucking Minimum Capacity
VMK16-10J, 12J, 16J-H	40, 42, 42
VMK20-12J, 16J, 20J-H	47, 47, 47

★ Tool shank tolerance : h6~h8