

**NEW**

**NIKKEN**

For Mill Turn Machine

# POLYGONAL TAPER C6 TOOLING

Rotating Tool

Machine performs  
100% of its capability.  
Cutting tool performs  
100% of its capability.



**NIKKEN KOSAKUSHO WORKS, LTD.**  
CAT.NO.6400E

# C6 MAJOR DREAM MILLING CHUCK

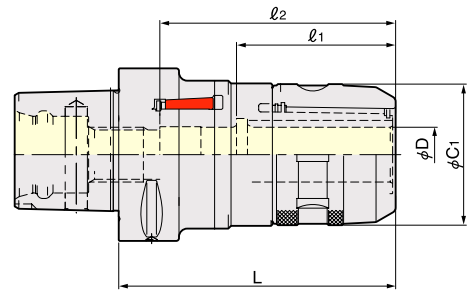
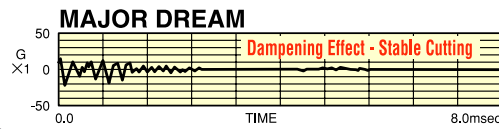

MDC

TAPER	Code No.	C <sub>1</sub>	D	l <sub>1</sub>	l <sub>2</sub>	Collet	Weight (Kg)
C6	<b>C6-MDC16- 90</b>	44	16	50	81	<b>KM16,CCK16</b>	1.4
	<b>-MDC20-100</b>	52	20	57	85	<b>KM20,CCK20</b>	1.8
	<b>-MDC25-110</b>	60	25	58	65	<b>KM25,CCK25</b>	2.2
	<b>-MDC32-130</b>	68	32	70	83	<b>KM32,CCK32</b>	2.5

★Please note the acceptable shank tolerance is h7.

★Spanner is available as an option.

C16:9HC16, C20:9HC22, C25:9HC25, C32:9HC32

★Please add "G" at the end of Code No. for the high speed milling chuck. e.g. C6-MDC16-90G



# STRAIGHT COLLET (KM, CCK)



KM

Photo shows ANNIVERSARY type KM Collet.



○ The internal helical groove, for oil drain purposes, prevents cutter slippage.

Explanation of the Code No.

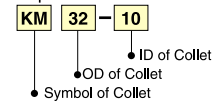

KM : Standard  
NK : Adjustable  
CCK : Centre Coolant  
CCKN : Centre Coolant, Adjustable

Style	L	KM Collet Code No. (OD-ID)
<b>(KM16)</b>	47.5	<b>KM16-2, 3, 4, 5, 6, 7, 8, 9, 10, 11, 12</b>
<b>(KM20)</b>	53	<b>KM20-2, 3, 4, 5, 6, 7, 8, 9, 10, 11, 12, 13, 14, 15, 16</b>
<b>(KM25)</b>	59	<b>KM25-3, 4, 5, 6, 7, 8, 9, 10, 11, 12, 13, 14, 15, 16, 17, 18, 19, 20, 21, 22</b>
<b>(KM32)</b>	64.5	<b>KM32-3, 4, 5, 6, 7, 8, 9, 10, 11, 12, 13, 14, 15, 16, 17, 18, 19, 20, 21, 22, 23, 24, 25, 26</b>

★ For Synchronous Tapping program : Special ID Collets for Tap shank are also available. 5.5, 6.2, 8.5, 10.5, 12.5

★The collets with bold character are "ANNIVERSARY" type KM collet.

Ordinary KM collet can be used with "ANNIVERSARY" type Milling Chuck, but better performance can be found with the "ANNIVERSARY" type KM collet.

★Please note the acceptable shank tolerances h6 - h7.



CCK

Photo shows ANNIVERSARY type CCK Collet.



CKFN Nut

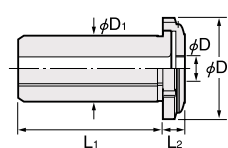

Explanation of the Code No.

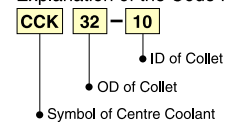

CCK Collet can be used as standard collet.

Style	φD <sub>1</sub>	φD <sub>2</sub>	L <sub>1</sub>	L <sub>2</sub>	CCK Collet Code No. (OD-ID)	Front Nut Code No.	Spanner Code No.
<b>(CCK16)</b>	16	28.5	45	8	<b>CCK16-3, 4, 5, 6, 8, 10, 12</b>	<b>CKFN16-□</b>	<b>CCKL16</b>
<b>(CCK20)</b>	20	33	50.5	8	<b>CCK20-6, 8, 10, 12, 16</b>	<b>CKFN20-□</b>	<b>CCKL20</b>
<b>(CCK25)</b>	25	39	56	8.5	<b>CCK25-6, 8, 10, 12, 16, 20</b>	<b>CKFN25-□</b>	<b>CCKL25</b>
<b>(CCK32)</b>	32	46.5, 43	61.5	9	<b>CCK32-6, 8, 10, 12, 16, 20, 25</b>	<b>CKFN32-□, CKFN32T-□</b>	<b>CCKL32, CCKL25</b>

★The collets with bold character are "ANNIVERSARY" type CCK collet.

★Please note the acceptable shank tolerances h6 - h7.

★Other metric sizes and imperial sizes, 1/8, 1/4, 5/16, 3/8, 7/16, 1/2, 5/8, 3/4, 13/16, 7/8, 1, 1-1/8, 1-1/4, 1-1/2 are available.

★Front Nut and CCKL Spanner are available as an option.

★Please insert ID into □ for the Code No. of the front nut. e.g. CKFN16-10

# GH Handle for HIGH SPEED TOOLING



GH

Code No.	Milling Chuck	Slim Chuck	MAJOR DREAM
<b>GH10</b> <sup>**</sup>	—	<b>SK10-P / SKT10</b>	<b>MDSK10</b>
<b>GH12</b> <sup>**</sup>	<b>C12-G</b>	<b>SK13-P / SKT13</b>	<b>MDSK13</b>
<b>GH16</b> <sup>**</sup>	<b>C16-G</b>	<b>SK16-P / SKT16</b>	<b>MDSK16</b>
<b>GH20</b> <sup>**</sup>	<b>C20-G</b>	<b>SK20-P / SKT20</b>	<b>MDSK20</b>
<b>GH25</b> <sup>**</sup>	<b>C25-G</b>	<b>SK25-P / SKT25</b>	<b>MDSK25</b>
<b>GH32</b>	<b>C32-G (Nose Ring : φ68mm)</b>	—	—

★Torque adjustable GH handle is available for the handle marked <sup>\*\*</sup>.  
The Code No. is GH10-TLS, GH12-TLS, GH16-TLS, GH20-TLS

# C6 MAJOR DREAM HOLDER

**NIKKEN**



## Dampening Effect ⊕ TiN Bearing Nut

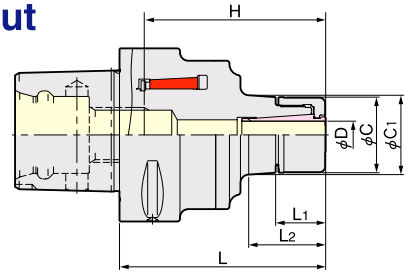
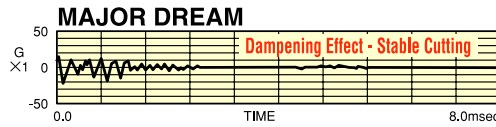

**MDSK**

TAPER	Code No.	D	L	L1	L2	C	C1	H	Collet	Weight (Kg)
<b>C6</b>	<b>C6-MDSK10- 65, 90</b>	3.0~10.0	65,90	18.2	19,43	27.5	27.5,31	56,81	<b>SK10-□A</b>	1.0,1.3
	<b>-MDSK13- 70, 90</b>	3.0~13.0	70,90	22	24,43	33	33.0,35.9	61,81	<b>SK13-□A</b>	1.0,1.3
	<b>-MDSK16- 70, 90</b>	3.0~16.0	70,90	23	24,43	40	40.0,42.8	61,81	<b>SK16-□A</b>	1.0,1.5
	<b>-MDSK20- 80, 90</b>	4.0~20.0	80,90	25.2	39.3,50.7	48	51,52.6	70,80	<b>SK20-□A</b>	1.6,1.9

- ★Please use A type SK Collet.
- ★GH Handle is available as an option. P.1
- ★Please refer NC TOOLING catalogue for the J type Nut and Cap.

# SLIUM CHUCK COLLET A TYPE

**NIKKEN**



**SK**

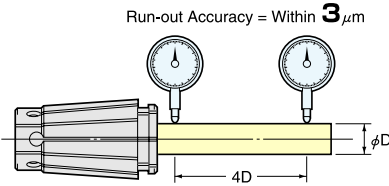

SK Collet a Type
<b>SK10-3A, 3.175A, 4A, 5A, 6A, 8A, 10A</b>
<b>SK13-3A, 4A, 5A, 6A, 8A, 10A, 12A</b>
<b>SK16-3A, 4A, 5A, 6A, 8A, 10A, 12A, 16A</b>
<b>SK20-4A, 5A, 6A, 8A, 10A, 12A, 16A, 20A</b>

★The acceptable Shank tolerance is hs.

# BASE HOLDER for MODULAR TYPE BORING BAR

**NIKKEN**



**MDQ**

**ZMAC**  
φ16~70mm

**RAC**  
φ25~100mm

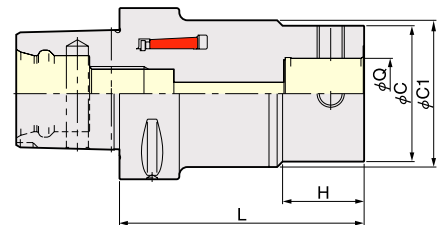

TAPER	Code No.	Q	L	C	C1	H	Weight (Kg)	ZMAC Boring Range
<b>C6</b>	<b>C6-MDQ26-90</b>	26	90	50	54	30	1.4	16~70

- ★The coupling screw and wrench are supplied as standard.
- ★Please refer NC TOOLING catalogue for the boring head and the spacer.

# TOOL CLAMPER for C6 TOOLING

**NIKKEN**



**TCL-63GH**

**Changeable Lever**  
Clamp / Neutral / Unclamp

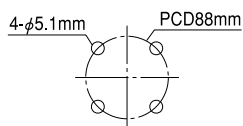

**Head**

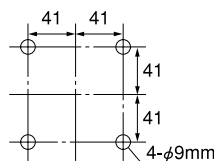

**Base**

TCL-63GH clumper is suitable for C6, HSK63A, HSK63E, HSK63F, BT40 and NC5-63.

# C6 MAJOR DREAM PRO-ENDMILL

**NIKKEN**

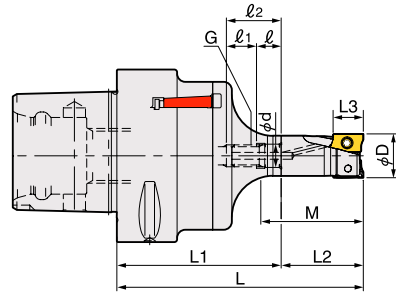

## C6-MDPE (Arbor + Head)

TAPER	Code No.	φD	L	L1	L2	MAX. Depth L3	M	Arbor Code No.	Head Code No.
C6	C6-MDPE16- 90, 110, 125	16	90,110,125	60,80,95	30	10	37.4	C6-MDPE-M 8- 60, 80, 95	M 8 -MDPE16-30
	-MDPE20- 95, 110, 125	20	95,110,125	65,80,95			40	-MDPE-M10- 65, 80, 95	M10-MDPE20-30
	-MDPE25- 95, 110, 125	25	95,110,125	60,75,90	35	15	45.3,47.5,47.5	-MDPE-M12- 60, 75, 90	M12-MDPE25-35
	-MDPE32-110, 125, 140	32	110,125,140	70,85,100	40		52.5	-MDPE-M16- 70, 85,100	M16-MDPE32-40

- ★Tip clamp bolts including one spare bolt and the tip clamp wrench are supplied as standard.
- ★Insert tip is not included. Please order separately.
- ★All types are centre through tool coolant type.

## C6-MDPE-M (Arbor)

TAPER	Code No.	φD	L1	φd	ℓ	ℓ1	ℓ2	G
C6	C6-MDPE-M 8-60, 80, 95	16	60,80,95	8.5	9	11	20	M 8
	-MDPE-M10-65, 80, 95	20	65,80,95	10.5		12	21	M10
	-MDPE-M12-60, 75, 90	25	60,75,90	12.5		15	24	M12
	-MDPE-M16-70, 85,100	32	70,85,100	17		16	25	M16

- ★PRO-ENDMILL head is not included. Please order separately.
- ★All types are centre through tool coolant type.

★When the connection interface (G and φd) is same, the other maker's cutter head can be used.

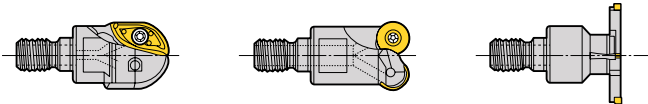

# PRO-ENDMILL Head & INSERT TIP

**NIKKEN**

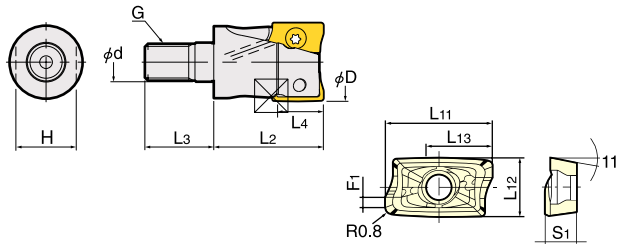

## AOMT (Insert Tip)

Tip Code No.	L11	L12	L13	S1	F1
AOMT123608PEER-M	12	6.6	10	3.6	1.2
AOMT184808PEER-M	18	9	15	4.8	1.4

- ★Nose R = 0.8 is only available. Please select MITSUBISHI insert tips for other Nose R.
- ★Grade is only VP15TF (Steel, Cast Iron, Harden Steel), please select MITSUBISHI insert tips for VP20RT (Stainless) or TF15 (Aluminium).
- ★Minimum order quantity is 10 pcs.

## M-MDPE (Head)

φD	Code No.	L2	L3	MAX. Depth L4	φd	G	No. of Tooth	Insert Tip	Tip Clamp Bolt	Tip clamp Wrench	Spanner Width H
16	M 8-MDPE16-30	30	18	10	8.5	M 8	2	AOMT123608PEER-M	TPS-25	TIP07F	10
20	M10-MDPE20-30		19		10.5	M10	3				14
25	M12-MDPE25-35	35	22	15	12.5	M12	2	AOMT184808PEER-M	TPS-4	TIP15W	19
32	M16-MDPE32-40	40	23		17.0	M16	3				24

- ★Tip clamp bolts including one spare bolt and the tip clamp wrench are supplied as standard.
- ★Insert tip is not included. Please order separately.
- ★All types are centre through tool coolant type.

## NIKKEN KOSAKUSHO WORKS, LTD. OSAKA, JAPAN.

5-1, 1-chome, Minamishinden, Daito-shi, Osaka-fu, Japan. Telephone:+0081 (0) 72-869-5820 Telefax:+0081 (0) 72-869-6220

U.S.A	LYNDEX-NIKKEN Tel.+001 (0) 847-367-4800	ITALY	VEGA INTERNATIONAL TOOLS S.P.A Tel.+0039 011-9456330/40/50~70	TURKEY	NIKKEN TURKEY Tel.+0090 (0) 216-5181010
FRANCE	PROCOMO-NIKKEN S.A.S Tel.+0033 (0) 1.69.19.17.35	SWITZERLAND	NIKKEN SWITZERLAND AG Tel.+0041 (0) 41-748-5000	KOREA	KOREA NIKKEN LTD. Tel.+0082 (0) 32-763-4461
UK	NIKKEN EUROPE Tel.+0044 (0) 1709-366306	SCANDINAVIA SWEDEN	NIKKEN SCANDINAVIA AB Tel.+0046 (0) 303-440600	P.R.CHINA	NIKKEN CHINA Tel.+0086 (0) 21-6210-2506
F.R.GERMANY	NIKKEN DEUTSCHLAND GmbH Tel.+0049 (0) 6142/55060-0	SPAIN	CUTTING TOOL S.L. Tel.+0034 (0) 902-820090		

http://www.nikken-world.com  
e-mail : export@nikken-kosakusho.co.jp

■Please give your order to the following agent.